

LEGS ON THE WALL

VENUE GUIDE AND
SPECIFICATIONS



THE RED BOX

is a powerfully distinctive space that was built by the NSW Ministry for the Arts in 2002 as a creative home for Sydney's Physical Theatre and large scale theatre communities. The facilities offer a high degree of customisation and access.



OVERVIEW

DIMENSIONS 23.89m x 19.89m (475 sq metres), 14m height

CAPACITY 207 pax (under specific configs and conditions this may be increased)

FEATURES high ceilings, aerial physical theatre rig, roll-in roll-out vehicle access

ACCESS rolling doors 7.2m wide x 4m high, level access

ELECTRICITY 3-phase: 3 x 32 amp outlets / 1 x 15 amp outlet / 18 x GPOs

3-PHASE EXTENSION 3-phase can be securely extended for external supply

SUSTAINABILITY the Red Box operates on solar power generated on site

SOUND Yamaha EMX 2000 mixer / 4 RCF ART300A speakers / 2 RCF 905-AS subs

CONDITIONING heaters and ventilation system (no air conditioning at this time)

TOILETS AND SHOWERS 1 accessible toilet / change room & accessible shower

womens: 6 cubicles, 4 showers and change room

mens: 4 cubicles, 5 urinals, 4 showers and change room

KITCHEN FACILITIES fridge, sink, microwave, kettle, toaster, water cooler

FIRE ALARM ISOLATION possible to arrange via contractor, charges applicable

SECURITY AND SAFETY alarm, 3 fire extinguishers, smoke detection, first aid kit

A SPACE FOR CREATIVITY

The Red Box was purpose-built to house physical theatre and aerial performance and is uniquely well-placed to foster the development of live performance and interdisciplinary art at any scale.

Legs On The Wall welcomes the opportunity to host colleagues and organisations who share a passion for physical theatre and other theatre practice, and we value our role as a meeting place and home for artist development and exchange.

With its unique dimensions, strength, and accessibility the Red Box is also a place to apply imagination to a range of possible activities including (and not limited to):

- theatre developments / rehearsals
- presentations / exhibitions / showcases
- workshops / training intensives
- filming / photography
- functions / private events
- meetings / small conferences





RIGGING AND FLOOR SPECIFICATIONS

SPRUNG DANCE FLOOR MAX LOADING 4.5kpa

(450kg per msq distributed)

FLOOR MAX LOADING - CONCRETE 5kpa

(500kg per msq distributed)

HEIGHT TO TRUSS 10m

HEIGHT TO CEILING 14m

TRUSS dead hung, 500mm performance box truss (10m high)

TRACK consultation with LOTW required for access to the wall track

ROOF The roof consists of two halves with primary and secondary roof members

ROOF LOADING 4 tonne maximum load per roof half. The maximum load applied to each primary rafter is 4 tonnes, the maximum load applied to each secondary roof member is 1 tonne

WALL COLUMNS there are 11 building columns able to be rigged to 1 tonne safe working load. Beam clamps available for hire

FLOOR POINTS 84 floor points (cast in ferrules) in an 8x9 grid of 2m intervals

FLOOR POINT LOADING 800 kg safe working load per M16 in cast in ferrules

SPRUNG DANCE FLOOR 14.4m x 13.2m in standard configuration with Tarkett. This can be removed (and for some activity must be removed) at hirer's cost (labour and on-costs)

RED BOX FLOOR polished concrete

Safe working loads indicated are static loads only

Dynamic loads must be converted to static loads (consult with LOTW if unsure)

Only certified riggers may use the rig and anchor points

RED BOX RIG PLAN

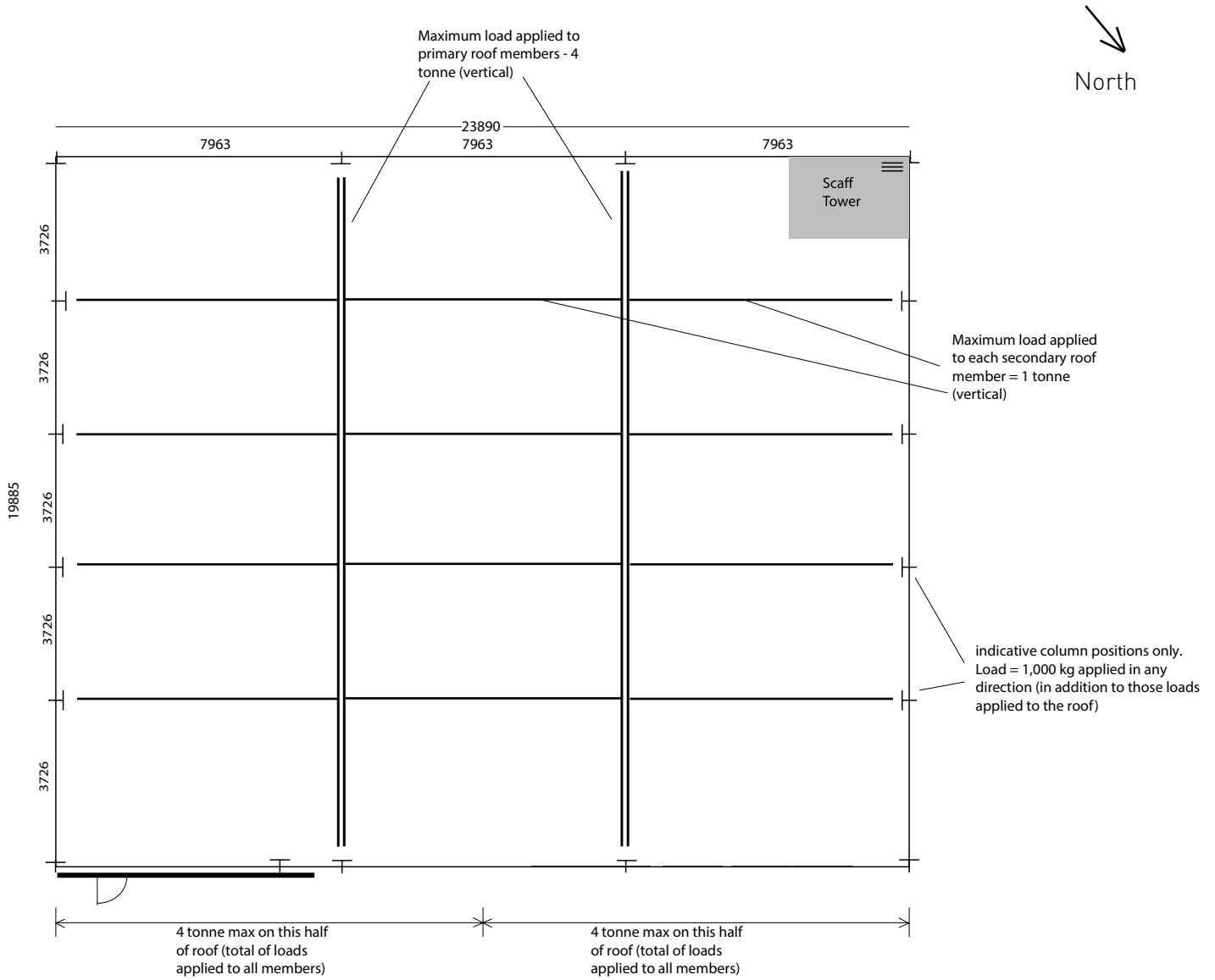

Drawing not to scale

91 CANAL ROAD LILYFIELD NSW

The traditional owners of the land we work on are the Gadigal and the Wangal of the Eora Nation.

91 Canal Road is managed by Create NSW and the site (and common area amenities) are shared with several other arts companies who have storage, workshops and working areas on the premises. It's a harmonious and relaxed site and we ask that hirers remain conscious of the other companies and personnel regularly working here (including the Legs team while at work or in rehearsal).

External areas and some spaces outside of Legs' footprint may be exclusively licensed for use for hire activity, with the approval of Create NSW. Legs can assist with this process, which involves some advance planning to mitigate impacts across the site.

Safe, thoughtful and respectful practice underpins all activity. Common areas operate on solar power generated on site.



A photograph of a long, empty industrial hallway. The hallway is viewed through a doorway from the right. The ceiling is high and features a complex network of dark wooden beams and trusses. The floor is a smooth, light-colored concrete. The walls are white brick. In the distance, there are some blue storage containers and a red fire extinguisher. The lighting is bright and even, highlighting the structural details of the space.

STUDIO ONE

is a rustic top floor
warehouse space in the
old Parachute Regiment
building, featuring large
windows with natural light
and stunning views over
Rodd Point



OVERVIEW

DIMENSIONS 52.02m x 23.12m (1,200 sq metres), 3m height (to rafters)

CAPACITY 220 pax

FEATURES rustic warehouse space, white brick walls, wooden pillars and rafters, harbour views, windows offering lots of natural light

ACCESS two pass-activated elevators to Level 3 make the Studio and associated amenities fully accessible

MAIN LIFT SPECS 2m wide, 2.5m high, 3.5m deep (doors: 1.9 x 2.2m)

LOADING access corridors on Level 3 are rated 3kPa (300kg per msq distributed)

FLOOR polished concrete with asphalt runway

ELECTRICITY 200 amp capacity 3-phase / 9 x GPOs (9 power points)

SUSTAINABILITY Studio One runs on a carbon neutral power supply

SOUND small portable PA system

TOILETS
1 private accessible bathroom situated within the Studio
Common area accessible bathroom (includes baby change table)
womens: 3 cubicles (one ambulatory accessible)
mens: 2 cubicles (one ambulatory accessible), 2 urinals

SHOWERS shared ground floor facilities (including 8 showers) are available for use

KITCHEN FACILITIES fridge, sink, microwave, kettle, toaster in shared kitchenette

FIRE ALARM ISOLATION possible to arrange via contractor, charges apply

SECURITY AND SAFETY padlocked entry point, secure lift access, first aid kit, 2 fire extinguishers and fire hose reel, smoke detection, 3 fire escapes accessible from within the studio (with space to shelter in place on Level 3)

A BLANK CANVAS WITH CHARACTER

Studio One overlooks the harbour to the north from the third floor of the former base of the Parachute Regiment, dating back to the 1940s.

The spacious footprint of the studio allows for subdivision of the space into separate areas of activity (e.g. a photographic shoot requiring spaces for dressing / waiting areas etc can all be accommodated within the studio). Other tenants have storage facilities on Level 3, so the level is shared space but the Studio itself is private.

In warmer months portable air conditioning units are recommended. Hire activity featuring music or noise needs to be considered with respect to our neighbours.

Studio One is well suited to accommodate:

- presentations / exhibitions / showcases
- creative developments / rehearsals
- workshops / training intensives
- filming / photography
- functions / private events
- meetings / small conferences



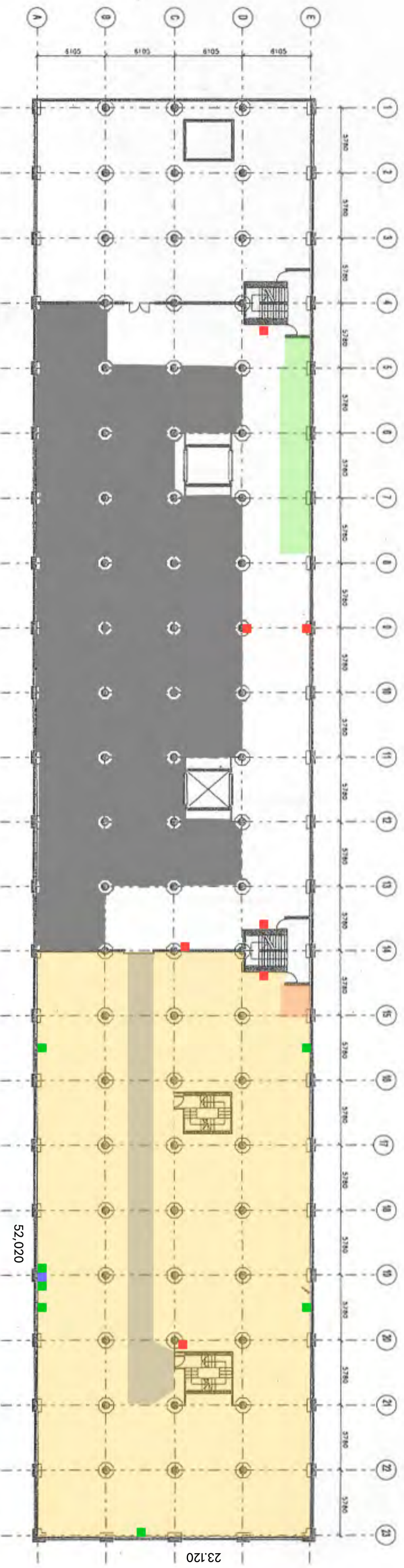

- Studio One Standard Hirable Area
- Bathrooms and Kitchen (shared spaces)
- Private accessible bathroom
- Asphalt Runway
- General Power Outlets
- Three Phase Power
- Fire Safety Equipment

NOTE: Studio One has a wooden pillar every 5.88m as indicated above

LEGS ON THE WALL

In 1984 a small collective of Sydney street performers took on the name of a warm up exercise and created a new physical theatre company. From these origins on Gadigal country, [Legs On The Wall](#) has grown to become the internationally renowned powerhouse it is today; with a reputation built on sharing vital contemporary stories through spectacularly daring public art. Inspired by this trailblazing legacy and led by Artistic Director Joshua Thomson and Associate Artist Vicki Van Hout, Legs remain a forward-facing company propelled by our mission: *to make meaning in a rapidly changing world through transformative physical theatre.*

Legs will happily consider being engaged for performance components to contribute to the creation of spectacularly unique events.

STANDARD VENUE HIRE OPERATIONS

With maximum scope for an inventive approach to events, and a near limitless to capacity to transform, our hires are “bare walls” hires, with the hirer to arrange or provide what they require from bump in to complete bump out.

Legs staff are on hand during regular business hours. Charges apply for attendance at other times. All hirers are provided with a comprehensive venue induction at the start of the hire period.

EQUIPMENT HIRE AND VENUE SERVICES

Legs have a range of equipment on hand which we hire at reasonable rates, including rigging, standard audio and electrical leads and equipment and other items.

Venues have chairs and tables suitable to meet standard rehearsal room requirements.

Legs will review hirer plans and risk assessments provided as part of standard safety practice. Charges apply, however, should Legs staff be required to be engaged with production planning, rigging, or technical support.

TRUSTED SUPPLIERS

Legs have strong relationships with a range of suppliers and can offer contacts in:

- Technical Equipment /operation
- Rigging / Engineering
- Security and Fire Safety (including isolation)
- Cleaning and Waste Management
- Lighting
- Catering
- Event Design
- Air Conditioning



physical



LEGS ON THE WALL

Click [here](#) to make a booking

Contact Details

admin@legsonthewall.com.au

+61 2 9560 9479

91 Canal Road, Lilyfield NSW
2040 Australia

[f](#) [@](#) @legsonthewall



Legs On The Wall is supported
by the NSW Government through
Create NSW